

# BRANCH OUTLETS / Style 88T

## QUIK-T™ BRANCH OUTLETS

Maximum working pressure: 300 psi  
For fire protection equipment and approved pressure ratings please contact Modgal.

## STYLE 88T

Cross Threaded

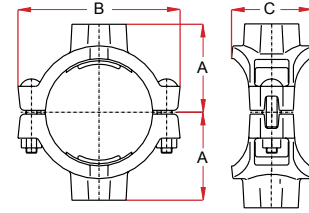
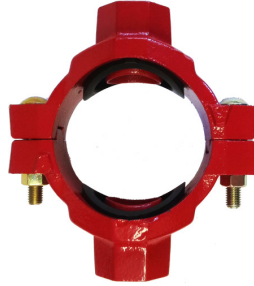

Nominal Size (Inches / DN)		Pipe Outside Diameter	Outlet Size	Quik-T™ Dimensions			Hole Diameter Tolerance +1/8"	Bolts			Weight Lbs	Approvals
Run	Outlet			A	B	C		Qty.	Size	Length		
2" / 50	1/2" / 15	2.375	1/2"	2.28	5.31	2.99	1 1/2"	2	3/8"	2 1/4"	3.75	FM / UL / LPCB / VDS
	3/4" / 20	2.375	3/4"	2.28	5.31	2.99	1 1/2"	2	3/8"	2 1/4"	3.84	FM / UL / LPCB / VDS
	1" / 25	2.375	1"	2.58	5.31	2.99	1 1/2"	2	3/8"	2 1/4"	4.16	FM / UL / LPCB / VDS
	1 1/4" / 32	2.375	1 1/4"	2.74	5.31	3.23	1 3/4"	2	3/8"	2 1/4"	4.25	FM / UL / LPCB / VDS
	1 1/2" / 40	2.375	1 1/2"	2.74	5.31	3.23	1 3/4"	2	3/8"	2 1/4"	4.21	FM / UL / LPCB / VDS
2 1/2" / 65	1/2" / 15	2.875	1/2"	2.64	5.91	3.62	1 1/2"	2	1/2"	3"	5.09	FM / UL
	3/4" / 20	2.875	3/4"	2.72	5.91	3.62	1 1/2"	2	1/2"	3"	4.98	FM / UL
	1" / 25	2.875	1"	2.83	5.91	3.62	1 1/2"	2	1/2"	3"	4.87	FM / UL
	1 1/4" / 32	2.875	1 1/4"	2.99	5.91	3.62	2"	2	1/2"	3"	4.94	FM / UL
	1 1/2" / 40	2.875	1 1/2"	2.99	5.91	3.62	2"	2	1/2"	3"	4.78	FM / UL
3" OD	1/2" / 15	3.000	1/2"	2.64	5.91	3.62	1 1/2"	2	1/2"	3"	5.10	FM / UL / LPCB / VDS
	3/4" / 20	3.000	3/4"	2.72	5.91	3.62	1 1/2"	2	1/2"	3"	4.99	FM / UL / LPCB / VDS
	1" / 25	3.000	1"	2.83	5.91	3.62	1 1/2"	2	1/2"	3"	4.87	FM / UL / LPCB / VDS
	1 1/4" / 32	3.000	1 1/4"	2.99	5.91	3.62	2"	2	1/2"	3"	4.93	FM / UL / LPCB / VDS
	1 1/2" / 40	3.000	1 1/2"	2.99	5.91	3.62	2"	2	1/2"	3"	4.78	FM / UL / LPCB / VDS
3" / 80	1/2" / 15	3.500	1/2"	2.80	6.30	3.15	1 1/2"	2	1/2"	3"	5.50	FM / UL / LPCB / VDS
	3/4" / 20	3.500	3/4"	2.99	6.30	3.15	1 1/2"	2	1/2"	3"	6.00	FM / UL / LPCB / VDS
	1" / 25	3.500	1"	3.05	6.30	3.15	1 1/2"	2	1/2"	3"	5.72	FM / UL / LPCB / VDS
	1 1/4" / 32	3.500	1 1/4"	3.44	6.30	3.70	2"	2	1/2"	3"	5.70	FM / UL / LPCB / VDS
	1 1/2" / 40	3.500	1 1/2"	3.44	6.30	3.70	2"	2	1/2"	3"	5.70	FM / UL / LPCB / VDS
	2" / 50	3.500	2"	3.54	6.30	4.02	2 1/2"	2	1/2"	3"	6.76	FM / UL / LPCB / VDS
4" / 100	1/2" / 15	4.500	1/2"	3.43	7.36	3.78	1 1/2"	2	1/2"	3"	6.80	FM / LPCB / VDS
	3/4" / 20	4.500	3/4"	3.50	7.36	3.78	1 1/2"	2	1/2"	3"	6.73	FM / LPCB / VDS
	1" / 25	4.500	1"	3.62	7.36	3.78	1 1/2"	2	1/2"	3"	6.51	FM / LPCB / VDS
	1 1/4" / 32	4.500	1 1/4"	4.09	7.36	3.78	2"	2	1/2"	3"	6.76	FM / UL / LPCB / VDS
	1 1/2" / 40	4.500	1 1/2"	4.09	7.36	3.78	2"	2	1/2"	3"	6.39	FM / UL / LPCB / VDS
	2" / 50	4.500	2"	4.09	7.36	4.21	2 1/2"	2	1/2"	3"	7.68	FM / UL / LPCB / VDS
	3" OD	4.500	3" OD	4.09	7.36	4.17	2 3/4"	2	1/2"	3"	10.80	FM / UL / VDS
5" OD	3" / 80	4.500	3"	4.41	7.36	5.12	3 1/2"	2	1/2"	3"	12.37	FM / UL / VDS
	1 1/4" / 32	5.500	1 1/4"	4.67	8.50	3.94	2"	2	5/8"	3 1/2"	9.39	FM / VDS
	1 1/2" / 40	5.500	1 1/2"	4.67	8.50	3.94	2"	2	5/8"	3 1/2"	9.12	FM / VDS
6" / 150	2" / 50	5.500	2"	4.74	8.31	4.17	2 1/2"	2	5/8"	3 1/2"	10.02	FM / VDS
	1 1/4" / 32	6.625	1 1/4"	5.24	9.65	3.78	2"	2	5/8"	4 3/4"	9.92	FM / LPCB / VDS
	1 1/2" / 40	6.625	1 1/2"	5.24	9.65	3.78	2"	2	5/8"	4 3/4"	9.91	FM / LPCB / VDS
	2" / 50	6.625	2"	5.12	9.65	4.21	2 1/2"	2	5/8"	4 3/4"	11.62	FM / LPCB / VDS
	3" OD	6.625	3" OD	5.53	9.72	4.61	2 3/4"	2	5/8"	4 3/4"	14.59	FM / LPCB / VDS
	3" / 80	6.625	3"	5.41	9.72	5.51	3 1/2"	2	5/8"	4 3/4"	14.56	FM / UL / VDS
8" / 200	4" / 100	6.625	4"	5.67	9.72	6.30	4 1/2"	2	5/8"	4 3/4"	17.75	FM / UL / VDS
	3" OD	8.625	3" OD	6.20	12.60	4.72	2 3/4"	2	3/4"	4 3/4"	15.41	-
	3" / 80	8.625	3"	6.34	12.60	5.55	3 1/2"	2	3/4"	4 3/4"	16.72	VDS
	4" / 100	8.625	4"	6.73	12.80	6.73	4 1/2"	2	3/4"	4 3/4"	23.48	VDS