

# GROOVED END ADAPTORS / Style 26 - 29

## GROOVED-END ADAPTORS

Maximum working pressure: 360 psi  
For fire protection equipment and approved pressure ratings please contact Modgal.

### STYLE 26

Reducing Elbow **STYLE 29**  
Elbow

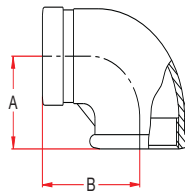
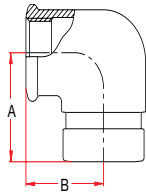

Nominal Size (Inches / DN)	Pipe Outside Diameter	Dimension		Weight Lbs	Approvals
		A	B		
1 1/4" G x 1/2" T 32G x 15T	1,660 x 839	1.73	1.50	0.53	-
1 1/4" G x 3/4" T 32G x 20T	1,660 x 1,050	1.83	1.50	0.62	-
1 1/2" G x 1/2" T 40G x 15T	1,900 x 839	1.81	1.57	0.66	UL
1 1/2" G x 3/4" T 40G x 20T	1,900 x 1,050	1.89	1.65	0.75	UL
1 1/2" G x 1" T 40G x 25T	1,900 x 1,315	2.09	1.69	0.88	UL
2" G x 1/2" T 50G x 15T	2,375 x 839	1.69	1.77	0.93	UL
2" G x 3/4" T 50G x 20T	2,375 x 1,050	1.77	1.81	0.99	UL
2" G x 1" T 50G x 25T	2,375 x 1,315	1.91	1.81	1.15	UL

Nominal Size (Inches / DN)	Pipe Outside Diameter	Dimension		Weight Lbsg.	Approvals
		A	B		
2" G x 2" T 50G x 50T	2,375 x 2,375	2.95	2.32	1.76	-

T = Threaded  
G = Grooved

T = Threaded  
G = Grooved

For use with higher than stated maximum working pressure, please contact Modgal Metal.